

# Dong Yang Servo Power Model Co.,Ltd

**MOTOR MODEL: BE2212-11 (1000KV)**

**MOTOR OUTLINES:**

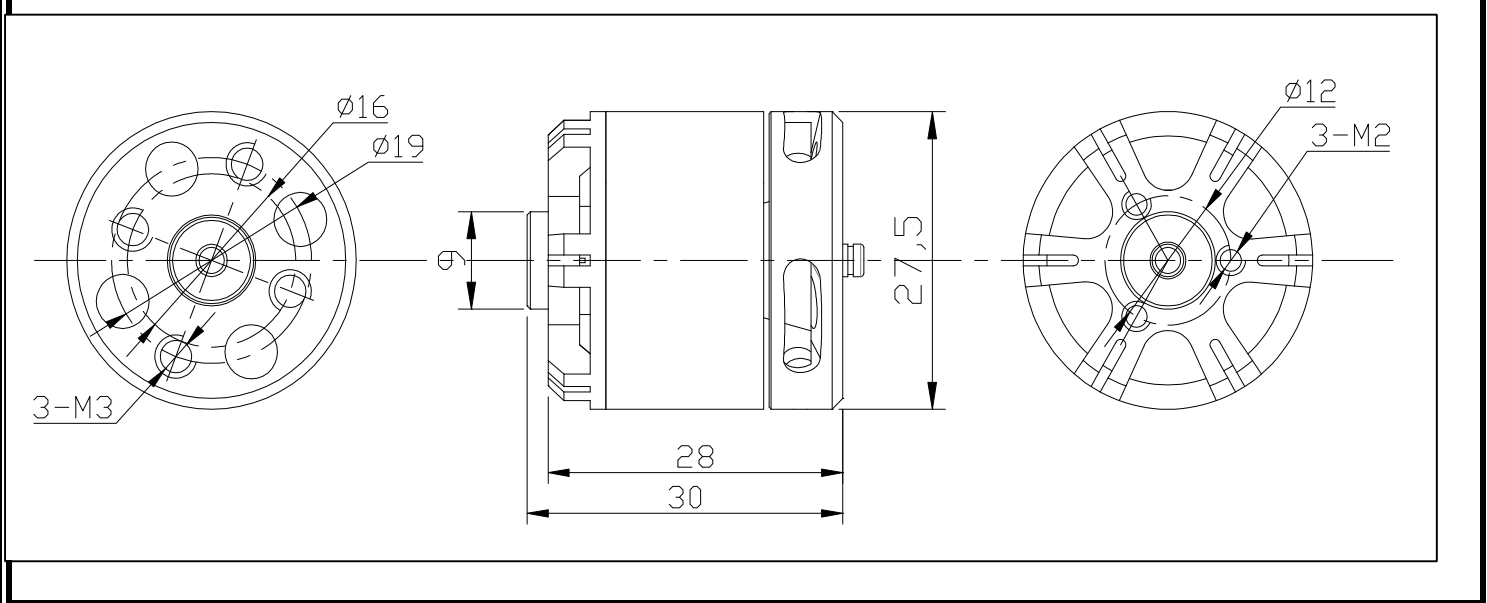

**MOTOR TECHNICAL DATA:**

Model	Weight	VOLTAGE V	NO LOAD		ON LOAD				LOAD TYPE
			CURRENT A	SPEED rpm	CURRENT A	SPEED rpm	Pull g	Power W	
BE2212-11 (1000KV)	57g	11.1	0.7	11323	5.4	9446	390	59.9	LiPo x 3/8X4. 5E
					9.9	7997	610	109.9	LiPo x 3/9X6E
					11	7183	710	122.1	LiPo x 3/10X4. 7E
		14.8			8.3	7740	630	122.8	LiPo x 4/8X4. 5SF
					13.6	6960	820	201.3	LiPo x 4/9X6SF
					14.6	6814	920	216.1	LiPo x 4/10X4. 7SF

In order to satisfy application requirement of those heavy-load multi-axis aircrafts, DYS final released BE series super strength out-runner multicopter dedicated brushless motor, The BE series motor is with Kawasaki, Japan 1200 # 0.2mm high efficiency silicon steel and 40UH high temperature powerful magnet. Selected the Japanese NSK pure imported bearings to reduce motor vibration, shell using high-precision CNC machining and professional balancing test, making concentricity, balance is greatly enhanced. DYS BE Series multicopter dedicated motor perfectly compatible with more than 99% of commercially available brushless ESC.

- Low vibration motor great for flying
- To make aircraft more stable
  - Less operating noise
  - More efficient
  - Bearings long life

1