

# Dong Yang Servo Power Model Co.,Ltd

MOTOR MODEL: BE2814-8(980KV)

MOTOR OUTLINES: (Weight:100g)

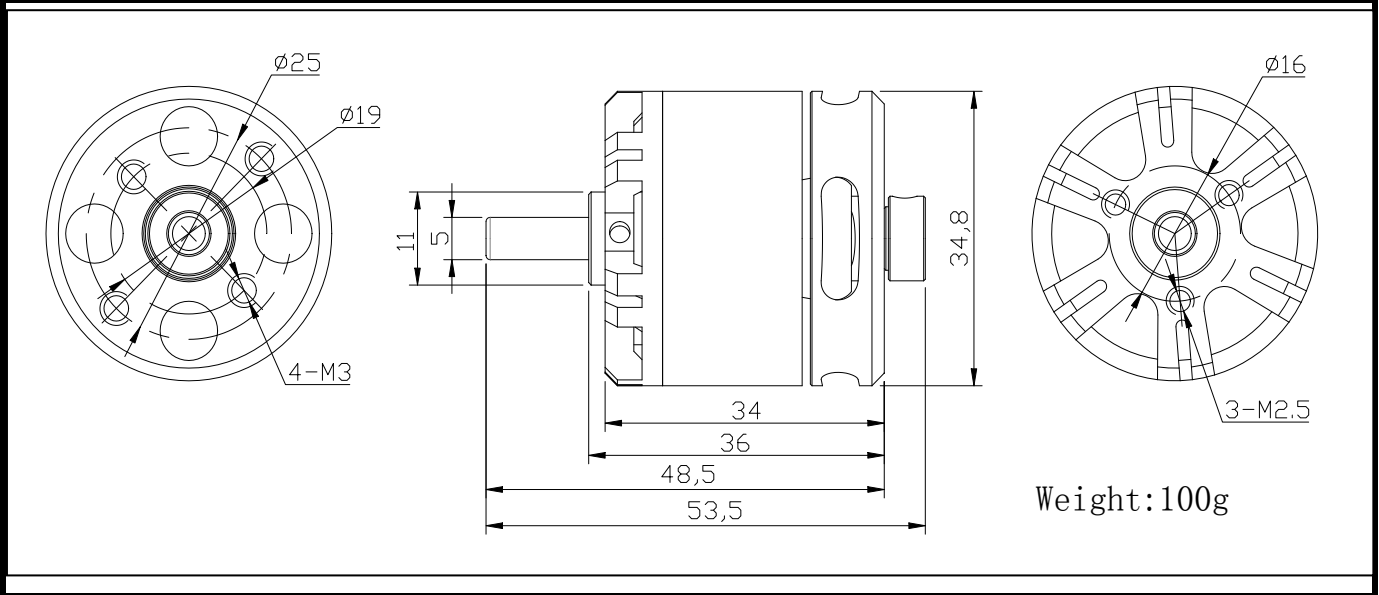

## MOTOR TECHNICAL DATA:

VOLTAGE	NO LOAD		ON LOAD			LOAD TYPE
	CURRENT	SPEED	CURRENT	Pull	Power	
V	A	rpm	A	g	W	Battery/prop
11.1	1.2	10810	12	560	133.2	LiPo x 3/7x5E
			13.7	770	152.1	LiPo x 3/8x4E
			16.8	1000	186.5	LiPo x 3/9x6E
			17.6	1120	195.4	LiPo x 3/10x5E
14.8	1.2	14410	19.2	930	284.2	LiPo x 4/7x5E
			21.4	1230	316.7	LiPo x 4/8x4E
			25.6	1520	378.9	LiPo x 4/9x6E
			27.6	1750	408.5	LiPo x 4/10x5E
18.5	1.3	18000	27.1	1320	501.4	LiPo x 5/7x5E
			30.5	1710	564.3	LiPo x 5/8x4E
			35.1	2120	649.4	LiPo x 5/9x6E
22.2	1.3	21610	35.9	1710	797.0	LiPo x 6/7x5E

DYS final released BE series super strength out-runner high-end brushless motor, The BE series motor is with Kawasaki, Japan 1200 # 0.2mm high efficiency silicon steel and 40UH high temperature powerful magnet. Selected the Japanese NSK pure imported bearings to reduce motor vibration, shell using high-precision CNC machining and professional balancing test, making concentricity, balance is greatly enhanced. DYS BE Series high-end brushless motor perfectly compatible with more than 99% of commercially available brushless ESC.

Low vibration motor great for flying

- To make aircraft more stable
- Less operating noise
- More efficient
- Bearings long life